

DOCUMENT 9927
REVISION P
October 7, 2009



Instruction Manual



Style 3

Taxiway Centerline Light (TCL) L-852A-C

Inset Runway Guard Light (RGL) L-852G

Inset Stopbar Light (SBL) L-852S

Cooper Industries
Crouse-Hinds Division
Airport Lighting Products
1200 Kennedy Road
Windsor, CT 06095

Copyright © 2009 Cooper Technologies Company
For Parts or Technical Service Call (860) 683-4300

Instruction Manual
Style 3
Taxiway Centerline Light L-852A-C
Inset Runway Guard Light L-852G
Inset Stopbar Light L-852S

1 Revisions

REV.	DESCRIPTION	LTR.	CHK.	APV
A	Initial Issue	A200-055	KWF	JMM
B	Revised pgs. 1,2,11. Item 10037-805 now 21109	A200-281	KWF	JMM
C	Page 1 Option 1, 48 Watt Lamp was 45 Watt	A201-281	PJG	JMM
D	Revised paragraph 8.0 Added Loctite requirement to paragraphs 9.2, 9.3, 9.5. Revised item 7 to 1.5" long. Added item 40, Loctite 242	A202-210	KWF	JMM
E	Corrected header revision letter	A202-210	KWF	JMM
F	Added O-ring, Item 41 in Parts List; Added Para 9.5 and renumbered following paras.; Updated Fig. 8	A203-142	6/11/03	GFR
G	Parts List, Item 21 was #10-32 x 1/2 LG	A204-244	10/19/04	GFR
H	Added Option G, Para. 10.8, Figure 9, and Item 42 to Table Para. 11	A205-082	4/29/05	GFR
J	Added lamp positioning note to Figure 8 and Para 10.2	A205-278	8/4/05	GFR
K	Revise bolt length from 3/8 x 7/8 to 3/8 x 1 1/2 in paragraphs 8.1 and 9.0 Added "Install new stainless steel, split-ring lock washers." Tp paragraphs 10.2, 10.4, 10.5, 10.6, 10.7, 10.8, 10.9. Added Loctite 242 recommendation to paragraph 10.12.4	A205-370	11/28/05	KWF
L	Added copyright to title pg & deleted from all other pg footers; pg 13, items 37 & 41, section 10.3 was 9.3	A206-426	11/6/06	PG
M	Deleted L-852D info; deleted Figure 1; 10.9, refer to Figure 8 was Figure 1; Parts List, item 9 qty for C3 was 2, item 28 P/N was 21130-Y, item 29 P/N was 21130-G, item 26 P/N was 21133-Y, item 27 P/N was 21133-G, added item 43-46; Figure 8, added item 43; FAA AC 150/5345-46C was -46B (all locations)	A208-103	5/20/08	PG
N	Parts List, Item 9 was 21115 & 304 Stn Stl was 18-8; FAA AC 150/5345-46D was 46C (all locations)	A209-101	7/15/09	JRC
P	Updated parts list, pg 13, items 44 was 21133-Y and 45 was 21133-C. Updated lamp positioning note on Figure 8, pg. 16	A209-159	10/7/09	JRC

Instruction Manual
Style 3
Taxiway Centerline Light L-852A-C
Inset Runway Guard Light L-852G
Inset Stopbar Light L-852S

2 Limited Product Warranty

THE FOLLOWING WARRANTY IS EXCLUSIVE AND IN LIEU OF ALL OTHER WARRANTIES, WHETHER EXPRESS, IMPLIED OR STATUTORY, INCLUDING, BUT NOT BY WAY OF LIMITATION, ANY WARRANTY OF MERCHANTABILITY OR FITNESS FOR ANY PARTICULAR PURPOSE.

Crouse-Hinds Airport Lighting Products (the “Company”) warrants to each original Buyer of Products manufactured by the Company that such Products are, at the time of delivery to the Buyer, free of material and workmanship defects, provided that no warranty is made with respect to:

- (a) any Product which has been repaired or altered in such a way, in Company’s judgment, as to affect the Product adversely;
- (b) any Product which has, in Company’s judgment, been subject to negligence, accident or improper storage;
- (c) any Product which has not been operated and maintained in accordance with normal practice and in conformity with recommendations and published specification of Company; and,
- (d) any Products, component parts or accessories manufactured by others but supplied by Company (any claims should be submitted directly to the manufacturer thereof).

Crouse-Hinds Airport Lighting Products’ obligation under this warranty is limited to use of reasonable efforts to repair or, at its option, replace, during normal business hours, at any authorized service facility of Company, any Products which in its judgment proved not to be as warranted within the applicable warranty period. All costs of transportation of Products claimed not to be as warranted and of repaired or replacement Products to or from such service facility shall be borne by Purchaser. Company may require the return of any Product claimed not to be as warranted to one of its facilities as designed by Company, transportation prepaid by Purchaser, to establish a claim under this warranty. The cost of labor for installing a repaired or replacement product shall be borne by Purchaser. Replacement parts provided under the terms of this warranty are warranted for the remainder of the warranty period of the Products upon which they are installed to the same extent as if such parts were original components thereof. Warranty services provided under the Agreement does not assure uninterrupted operations of Products; Company does not assume any liability for damages caused by any delays involving warranty service. The warranty period for the Products is 24 months from date of shipment or 12 months from date of first use whichever occurs first.

Instruction Manual
Style 3
Taxiway Centerline Light L-852A-C
Inset Runway Guard Light L-852G
Inset Stopbar Light L-852S

3 Safety Notices



NOTICE

NOTICE:

This equipment is normally used or connected to circuits that may employ voltages that are dangerous and may be fatal if accidentally contacted by operating or maintenance personnel. Extreme caution should be exercised when working with this equipment. While practical safety precautions have been incorporated in this equipment, the following rules must be strictly observed.

3.1 Keep Away from Live Circuits



DANGER

DANGER:

Operating and maintenance personnel must at all times observe all safety regulations. Do not perform maintenance on internal components or re-lamp with power ON.

3.2 Resuscitation

Maintenance personnel should familiarize themselves with the technique for resuscitation found in widely published manuals of first aid instructions.



IMPORTANT

IMPORTANT:

See FAA Advisory Circular AC 150/5340-26 for additional information.

Instruction Manual
Style 3
Taxiway Centerline Light L-852A-C
Inset Runway Guard Light L-852G
Inset Stopbar Light L-852S

4 SAFETY SYMBOLS



DANGER

The hazard or unsafe practice will result in severe injury or death.

DANGER:



WARNING

The hazard or unsafe practice could result in severe injury or death.

WARNING:



CAUTION

The hazard or unsafe practice could result in minor injury.

CAUTION:



NOTICE

Possibly dangerous situation, goods might be damaged.

NOTICE:



IMPORTANT

Helpful information.

IMPORTANT:

Instruction Manual
Style 3
Taxiway Centerline Light L-852A-C
Inset Runway Guard Light L-852G
Inset Stopbar Light L-852S

5 Table of Contents

Title Page	i
1 Revisions	ii
2 Limited Product Warranty	iii
3 Safety Notices	iv
4 Safety Symbols	v
5 Table of Contents	vi
6 Part Number Explanation – Taxiway Centerline Light, L-852 A-C	1
7 Part Number Explanation – Inset Runway and Stopbar Light, L-852 G & S	2
8 General Description	3
8.1 Taxiway Centerline Light, L-852A	3
8.2 Taxiway Centerline Light, L-852B	3
8.3 Taxiway Centerline Light, L-852C	3
8.4 Not Used	3
8.5 Inset Runway Guard light, L-852G	4
8.6 Inset Stopbar Light, L-852S	4
9 Installation	5
10 Maintenance	5
10.1 Cleaning Lenses	5
10.2 Relamping	6
10.3 Seal Revisions	6
10.4 Gasket Replacement	7
10.5 O-Ring Replacement	7
10.6 Lens Replacement	8
10.7 Feed-thru Replacement	8
10.8 External Support Ring Gasket Replacement	9
10.9 Wedge Filter Replacement	9
10.10 Pressure Test	10
10.11 Cleanliness and Workmanship	10
10.12 Maintenance Program	10
11 Parts List	13
Figure 1 Not Used	9
Figure 2 Wedge Filter Bracket Assembly	9
Figure 3 19999 Installation (Lifting) Tool	12
Figure 4 Top View of Fixture	14
Figure 5 Side View of Fixture	14
Figure 6 Feed-thru adapter detail	15
Figure 7 Bottom View of Fixture	15
Figure 8 Cut-away View of Fixture	16
Figure 9 Side View of Fixture with Optional External Support Ring Gasket	17

Instruction Manual
Style 3
Taxiway Centerline Light L-852A-C
Inset Runway Guard Light L-852G
Inset Stopbar Light L-852S

6 Part Number Explanation – Taxiway Centerline Light, L-852A, B & C

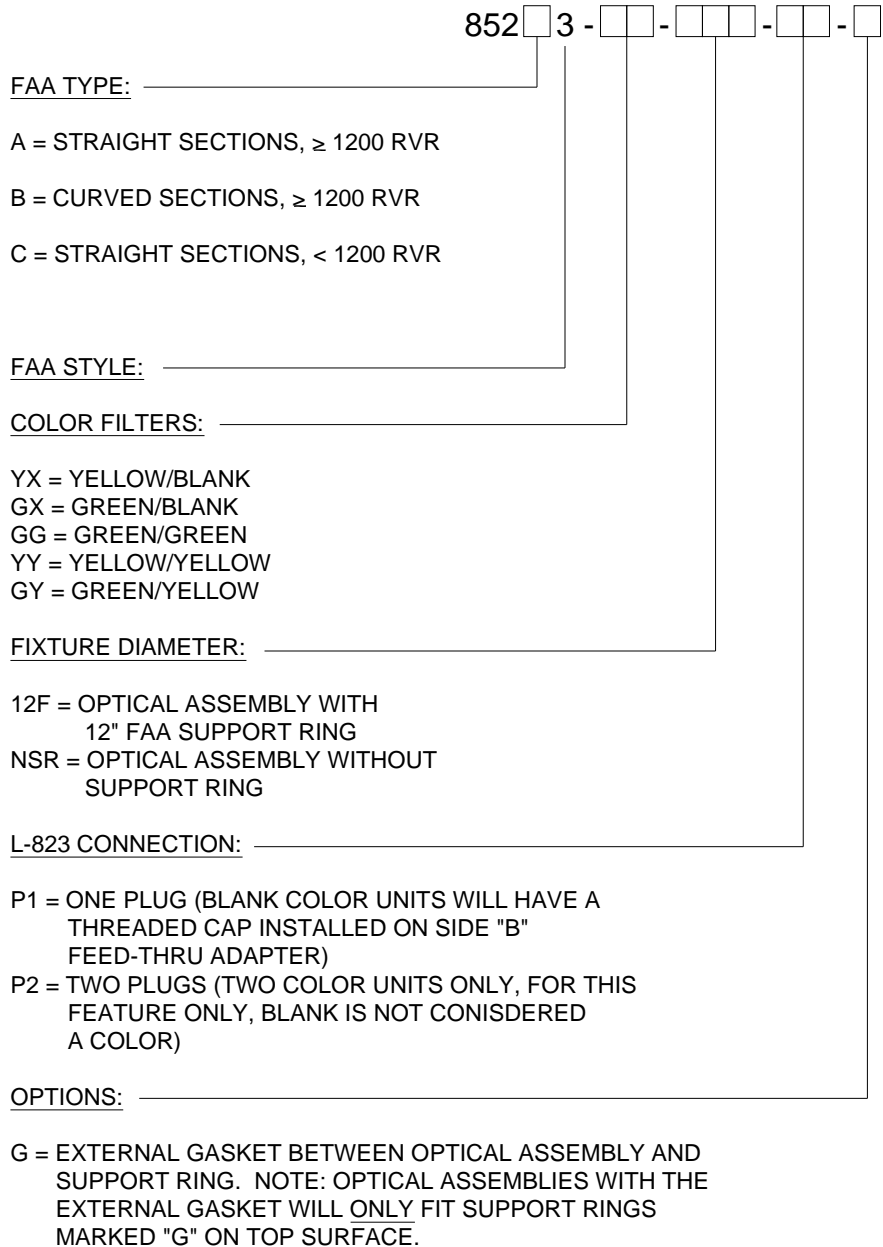

Instruction Manual
Style 3
Taxiway Centerline Light L-852A-C
Inset Runway Guard Light L-852G
Inset Stopbar Light L-852S

7 Part Number Explanation – Inset Runway and Stopbar Light, L-852G & S

852 3 - - -

FAA TYPE: _____

G = INSET RUNWAY GUARD LIGHT

S = INSET STOPBAR LIGHT

FAA STYLE: _____

COLOR FILTERS: _____

- Y = YELLOW (852G3 ONLY)
- YX = YELLOW/BLANK (852G3 ONLY)
- R = RED (852R3 ONLY)
- RX = RED/BLANK (852R3 ONLY)

FIXTURE DIAMETER: _____

NSR = OPTICAL ASSEMBLY WITHOUT
SUPPORT RING

OPTIONS: _____

G = EXTERNAL GASKET BETWEEN OPTICAL ASSEMBLY AND
SUPPORT RING. NOTE: OPTICAL ASSEMBLIES WITH THE
EXTERNAL GASKET WILL ONLY FIT SUPPORT RINGS
MARKED "G" ON TOP SURFACE.

Instruction Manual
Style 3
Taxiway Centerline Light L-852A-C
Inset Runway Guard Light L-852G
Inset Stopbar Light L-852S

8 General Description

8.1 Taxiway Centerline Light, L-852A

The Crouse-Hinds Style 3 Taxiway Centerline Light is an ITS verified FAA L-852A per FAA AC 150/5345-46D. It is designed for installation at the centerline of taxiways or any other location where visual guidance of moving aircraft or ground vehicles is desirable. The fixture is designed to fit on a FAA L-868, steel, Size B light base per FAA AC 150/5345-42 (latest version), and have a total height above grade/ground level of < .250 inch. The fixture is bi-directional, projecting two beams of light 180° apart. It is weatherproof and will endure roll over loads without damage. The light fixture consists of a ductile iron support ring and a removable aluminum optical assembly. The ductile iron ring is mounted to a light base with six bolts (3/8-16 UNC x 1½ lg., stn. stl.) and lock washers (3/8, stn. Stl.). The aluminum optical housing is secured to the ductile iron ring using two bolts, (3/8-16 UNC x 1½ lg., stn. stl.) and lock washers (3/8, stn. Stl.) and two high-strength shear pins. The optical housing has a die cast bottom housing that is attached using 4 screws. A polyurethane o-ring is used to provide a watertight seal between the inner cover and the optical housing (See Section 10.3). An optional silicone gasket is bonded to the outside of the inner cover to provide a watertight seal between the optical assembly and the ductile iron support ring. Two 32-watt, MR-16 lamps are secured to two brackets, which are fastened to the bottom housing. Electrical connections are made at either one or two feed-thru assemblies in the inner cover. The feed-thrus have ITS verified L-823 plugs for connecting to FAA L-830/ L-831 Isolation Transformers. Lenses are held into the aluminum housing with a bracket, gasket, molded elastomeric boot and two screws. There is a wedged shaped glass filter mounted to the optical housing between each lamp and lens. The light beam color is changed when it passes through the wedge, which can be changed in the field.. All hardware is type 18-8 stainless steel. The complete light unit is 11.94 inches in diameter, 3.63 inches deep, and weighs 20 lbs.

8.2 Taxiway Centerline Light, L-852B

The Crouse-Hinds Taxiway Centerline Light is an ITS verified FAA L-852B per FAA AC 150/5345-46D. Its design is identical to the L-852A described in section 8.1, with the exception that it has a wedged shaped filter with fresnel lensing between the lamp and lens.

8.3 Taxiway Centerline Light, L-852C

The Crouse-Hinds Taxiway Centerline Light is an ITS verified FAA L-852C per FAA AC 150/5345-46D. Its design is identical to the L-852A described in section 8.1.

8.4 Not Used

Instruction Manual
Style 3
Taxiway Centerline Light L-852A-C
Inset Runway Guard Light L-852G
Inset Stopbar Light L-852S**8.5 Inset Runway Guard Light, L-852G**

The Crouse-Hinds Style 3 Inset Runway Guard Light is an ITS verified FAA L-852G per FAA AC 150/5345-46D. It is designed for installation at the intersection of taxiways and runways where visual guidance of moving aircraft is desirable. The fixture is designed to fit on a FAA L-868, steel, Size B light base per FAA AC 150/5345-42(latest version), and have a total height above grade/ground level of < .250 inch. The fixture is unidirectional. It is weatherproof and will endure roll over loads without damage. The light fixture consists of a ductile iron support ring and a removable aluminum optical assembly. The ductile iron ring is mounted to a light base with six bolts (3/8-16 UNC x 1½ lg., stn. stl.) and lock washers (3/8, stn. Stl.). The aluminum optical housing is secured to the ductile iron ring using two bolts, (3/8-16 UNC x 1½ lg., stn. stl.) and lock washers (3/8, stn. Stl) and two, high-strength shear pins. The optical housing has a die cast inner cover housing that is attached using 4 screws. A polyurethane o-ring is used to provide a watertight seal between the inner cover and optical housing (See Section 10.3). An optional silicone gasket is bonded to the outside of the inner cover to provide a watertight seal between the optical assembly and the ductile iron support ring. A 105-watt, MR-16 lamp is secured to a bracket, which is fastened to the bottom housing. Electrical connections are made at a feed-thru assembly in the inner cover. The feed-thru has an ITS verified L-823 plug for connecting to an FAA L-830/ L-831 Isolation Transformer. The lens is held in the aluminum housing with a bracket, gasket, molded elastomeric boot and two screws. There is a wedged shaped glass filter with fresnel lensing mounted to the optical housing between the lamp and lens. The light beam color is traffic signal yellow. All hardware is type 18-8 stainless steel. The complete light unit is 11.94 inches in diameter, 3.63 inches deep, and weighs 20 lbs.

8.6 Inset Stopbar Light, L-852S

The Crouse-Hinds Inset Stopbar Light is an ITS verified FAA L-852S per FAA AC 150/5345-46D. Its design is identical to the L-852G described in section 8.5, with the exception that the light beam color is traffic signal red.

**CAUTION****CAUTION:**

Never handle the light assembly by the leads as this can break the waterproof seal.

Instruction Manual
Style 3
Taxiway Centerline Light L-852A-C
Inset Runway Guard Light L-852G
Inset Stopbar Light L-852S

9 INSTALLATION

The Style 3 TCL, RGL, and SBL light units are shipped complete, including the lamp(s), and are ready for installation as received. Installation of a light unit is to be done with primary POWER OFF and SECURED. At each light location, install a steel, Size B, 12 inch deep minimum, L-868 Light Base per FAA AC 150/5340-4 (latest revision). For TCL fixtures, install the light base with two opposite bolt holes perpendicular to the taxiway centerline. For RGL and SBL fixtures, install the light base with two opposite bolt holes parallel to the runway centerline. Place the properly sized isolation transformer(s) in the light base and make necessary primary power connections using L-823 connectors. The TCL light unit requires either two 45 watt, 6.6A secondary transformers for the two lead version, or one 100 watt, 6.6A secondary transformer for the single lead version. The RGL and SBL light units require one 100 watt, 6.6A secondary transformer. Verify that the mounting flange on the light base is clean and the o-ring (optional on deep cans) is coated with Dow Corning FS 1292 grease and is in place on the light base. Connect the plug(s) from the light unit to the secondary(ies) of the previously installed isolation transformer(s). Installation tool, Crouse-Hinds P/N 19999, will ease in the installation and removal of the light unit (See Figure 1). The threaded eyebolts on the lifting tool screw into threaded holes in the light fixture. Lower the light unit straight down onto the base. The light fixture is subject to optical misalignment or mechanical damage if not seated properly. Verify the light beam(s)/color(s) are properly orientated for the individual location. Secure the light fixture to the base with six 3/8-16 UNC x 1½ lg. stn. Stl. bolts and lockwashers and tighten to 225 -0 +10 in-lbs. (18 ft-lbs.). It is recommended that Loctite 242 be used on the mounting bolts to prevent loosening due to vibration. It is highly recommended for fixtures subjected to repeated aircraft impacts and roll-overs.

10 MAINTENANCE

The preferred method of maintaining these lights is to periodically and systematically replace the Optical Assembly and return it to the maintenance shop for renovation. As an alternative, the Optical Assembly can be serviced in the field. However, it is recommended that field servicing be limited to cleaning the lens as described in section 10.1 and to lamp replacements as described in section 10.2.

10.1 Cleaning Lenses

With a compressed air blast or suitable brushes, remove all accumulated debris from the light channel. Clean the outer surface of the prism with a detergent solution. If the lens is coated with a substance impervious to the detergent, a suitable solvent should be sparingly applied with a wad of cotton or a patch of cloth on the end of a wood splint. After the solvent has acted the remaining solvent and softened coating should be removed with a clean piece of cotton or cloth. Care should be taken to avoid excessive contact between the solvent and the lens seal. Remove all remaining solvent from lens and seal. A gentle air blast may be used.

Instruction Manual
Style 3
Taxiway Centerline Light L-852A-C
Inset Runway Guard Light L-852G
Inset Stopbar Light L-852S**10.2 Relamping****WARNING**

Light assembly parts are hot when lamp is energized and remain hot for a short time after lamp/fixture is turned off.

WARNING

Remove and secure power to the fixture. Separate the Optical Assembly from the outer ring by removing the two bolts. There are two pry slots in the optical housing to help separate the Optical Assembly from the support ring. Turn the Optical Assembly upside down and remove the four screws holding the inner cover to the light housing. Disconnect the lamp leads from the feed-thru terminals. Remove the Lamp Assembly by gently pulling up on the lamp reflector base. Inspect the feed-thru terminal for signs of corrosion. Replace feed-thru assemblies per paragraph 10.7. Clean the inside surfaces of the lens(es) with denatured alcohol. Inspect the lamp holder bracket(s) for loose hardware; tighten the mounting screws to 30 in-lbs.

**CAUTION**

Touching the quartz bulb with bare fingers may seriously shorten lamp life. If the bulb has been touched, wipe it clean with a piece of lens cleaning tissue or similar material moistened with denatured alcohol.

CAUTION

Install the new lamp by reversing the procedure above. Make certain the rim of the reflector is flush against the bracket and seated against the two pins at the bottom of the bracket. Position lamp as shown in Figure 8. Connect the lamp leads to the feed-thru terminals. Inspect/replace the inner cover o-ring per paragraph 10.5 (See Section 10.3). Assemble the inner cover onto the light housing. The screw hole patterns in the inner cover and light housing are offset to insure proper alignment. Tighten the mounting screws to 30 in-lbs. Clean the mounting flange area of the support ring. Place the Optical Assembly into the support ring. Install new stainless steel, split-ring lock washers. Apply Loctite 242 (P/N 10048-30), per manufacturer's instructions, to both mounting bolts and immediately torque them to 225 -0+10 in-lbs.

10.3 Seal Revisions

Fixtures manufactured prior to May 2003 use a high temperature silicone gasket (P/N 21124), bonded to the inner cover (P/N 21118-X), to provide a watertight seal between the inner cover and the optical housing (P/N 21105-X). Paragraph 10.4, Gasket Replacement, details the instructions on how to replace the 21124 gasket. Starting in May 2003, a polyurethane o-ring (P/N 10035-62) was used to provide the watertight seal between the optical housing and inner cover. The o-ring is not bonded to either the optical housing or inner cover. This revision requires an o-ring groove to be machined into the 21105-X optical housing, and all replacement optical housings will be supplied with the o-ring groove. Paragraph 10.5, O-Ring Replacement, details the instructions on how to replace the 10035-62 o-ring. To retrofit an older style inner cover to the o-ring groove style optical housing, cut the 21124 gasket flush with the mounting surface on the inner cover with a razor blade.

Instruction Manual
Style 3
Taxiway Centerline Light L-852A-C
Inset Runway Guard Light L-852G
Inset Stopbar Light L-852S**10.4 Gasket Replacement**

Everytime the Optical Assembly is opened the gasket must be closely examined and replaced if necessary. Any gasket that is stretched, torn, has a permanent set or some other defect, which would prevent it from forming a watertight seal, must be replaced with a new gasket. Remove the old gasket from the groove in the inner cover. Carefully clean the flange mating surfaces and the inner cover groove. This can be done by carefully scraping. Take care not to damage the mating surface and the bottom and sides of the groove. Coat the gasket (P/N 21124) with a thin layer of Dow Corning FS 1292 Lubricating grease. Position the new gasket in the center of the groove and press it into place. The grease will hold the gasket in place while the inner cover is positioned on the light housing. Torque the inner cover screws to 30 in-lbs. Perform a pressure test as described in paragraph 10.10. Clean the mounting flange area of the support ring. Place the Optical Assembly into the support ring. Install new stainless steel, split-ring lock washers. Apply Loctite 242 (P/N 10048-30), per manufacturer's instructions, to both mounting bolts and immediately torque them to 225 -0+10 in-lbs.

**IMPORTANT*****IMPORTANT***

The groove is designed to be wider than the gasket. This provides room for displacement of the gasket when compressed between the housing and mating surface. Properly tightened screws are important in obtaining a complete seal.

10.5 O-Ring Replacement

Everytime the Optical Assembly is opened the o-ring must be closely examined and replaced if necessary. Any o-ring that is stretched, torn, has a permanent set or some other defect, which would prevent it from forming a watertight seal, must be replaced with a new o-ring. Remove the old o-ring from the groove in the optical housing. Carefully clean the o-ring groove and flange mating surface on the inner cover. Take care not to damage the mating surface or o-ring groove. Coat the o-ring (P/N 10035-62) with a thin layer of Dow Corning FS 1292 Lubricating grease. Position the new o-ring in the groove and press it into place. Torque the inner cover screws to 30 in-lbs. Perform a pressure test as described in paragraph 10.10. Clean the mounting flange area of the support ring. Place the Optical Assembly into the support ring. Install new stainless steel, split-ring lock washers. Apply Loctite 242 (P/N 10048-30), per manufacturer's instructions, to both mounting bolts and immediately torque them to 225 -0+10 in-lbs.

***IMPORTANT***

Instruction Manual
Style 3
Taxiway Centerline Light L-852A-C
Inset Runway Guard Light L-852G
Inset Stopbar Light L-852S**IMPORTANT**

*A bad gasket or o-ring seal is the most common cause of inset fixture leaks. **It is strongly recommended** that a new gasket or o-ring be installed every time the Optical Assembly is opened.*

10.6 Lens Replacement

If a lens is broken, leaks or is badly pitted or scarred, it must be replaced. It is highly recommended that this task be performed in a clean shop environment. Lens Replacement Kit P/N 21126-C contains all necessary parts to change a lens. **Remove and secure power to the fixture.** Separate the Optical Assembly from the outer ring by removing the two bolts. Turn the Optical Assembly upside down and remove the four screws holding the inner cover to the light housing. Remove the two lens retaining bracket screws from the light housing. Remove the lens-retaining bracket and discard the lens-retaining gasket. Firmly push the lens/boot assembly from the outside of the light housing; discard the old lens and boot. Thoroughly clean the lens opening with denatured alcohol and allow to dry. Inspect the lens opening for scratches or pits, a damaged lens opening surface will not seal properly. Place a new lens boot (P/N 21103) over the replacement lens (P/N 21102-C). Apply a thin coat of Dow Corning FS 1292 grease over the entire outside surface of the lens boot. Align the lens/boot assembly in the lens opening and press it into place. Verify that the lens boot is not pinched in the lens opening. Using a new lens retaining gasket (P/N 21101), fasten the lens retaining bracket (P/N 21100) to the light housing. Torque the mounting screws to 30 in-lbs. Assemble the inner cover onto the light housing. The screw hole patterns in the inner cover and light housing are offset to insure proper alignment. Torque the mounting screws to 30 in-lbs. Perform a pressure test per paragraph 10.10. Clean the mounting flange area of the support ring. Place the Optical Assembly into the support ring. Install new stainless steel, split-ring lock washers. Apply Loctite 242 (P/N 10048-30), per manufacturer's instructions, to both mounting bolts and immediately torque them to 225 -0+10 in-lbs.

10.7 Feed-thru Replacement

Remove and secure power to the fixture. Separate the Optical Assembly from the outer ring by removing the two bolts. Turn the Optical Assembly upside down and remove the four screws holding the inner cover to the light housing. Disconnect the lamp leads from the feed-thru terminals. Remove the feed-thru by unscrewing the retaining collar. Clean the mounting surface with Isopropyl Alcohol and allow to dry. Apply a thin coat of Dow Corning FS 1292 grease to the mounting flange of a new feed-thru (P/N 21121 for 2 lamp/ 1 plug, or P/N 21122 for 1 lamp/ 1 plug). Apply a drop of Loctite 242 to the feed-thru adapter threads. Screw the feed-thru retaining collar onto the adapter; refer to Figure 5 for proper inner cover/ feed-thru orientation. Torque the retaining collar to 30 in-lbs. Assemble the inner cover onto the light housing. The screw hole patterns in the inner cover and light housing are offset to insure proper alignment. Torque the mounting screws to 30 in-lbs. . Perform a pressure test per paragraph 10.10. Clean the mounting flange area of the support ring. Place the Optical Assembly into the support ring. Install new stainless steel, split-ring lock washers. Apply Loctite 242 (P/N 10048-30), per manufacturer's instructions, to both mounting bolts and immediately torque them to 225 -0+10 in-lbs.

Instruction Manual
Style 3
Taxiway Centerline Light L-852A-C
Inset Runway Guard Light L-852G
Inset Stopbar Light L-852S

10.8 External Support Ring Gasket Replacement

Every time a light fixture with the optional external support ring gasket is removed from the light base, the gasket on the inner cover should be examined and replaced if necessary. Any gasket that is stretched, torn, has a permanent set or some other defect, will allow water to enter the light base. Remove the old gasket from the inner cover by carefully scraping. Take care not to damage the inner cover. Form a thin bead of high temperature silicone adhesive, such as GE RTV 106, on the inner cover sealing service. Position the new gasket (P/N 21180) on the inner cover in the same location as the old gasket. Allow the silicone to cure for 4 to 12 hours. Cure times depend on the amount of silicone use, ambient temperature, and relative humidity. Apply a thin coat of Dow Corning FS 1292 grease over the entire outside surface of the gasket before placing in the support ring. Install new stainless steel, split-ring lock washers. Apply Loctite 242 (P/N 10048-30), per manufacturer's instructions, to both mounting bolts and immediately torque them to 225 -0+10 in-lbs.

10.9 Wedge Filter Replacement

The wedge filter in the 852X3 series fixtures determines the FAA type and color of the light beam. It can be replaced in the field. It is highly recommended that this task be performed in a clean shop environment. **Remove and secure power to the fixture.** Separate the Optical Assembly from the outer ring by removing the two bolts. Turn the Optical Assembly upside down and remove the four screws holding the inner cover to the light housing. Note the orientation of the filter in the filter bracket assembly. The position of the filter in the bracket will affect photometric performance. Slide the filter out of the spring loaded bracket assembly. Place two new P/N 21132 wedge gaskets on the replacement filter mounting tabs, and slide the filter into position in the bracket. Refer to Figure 8 for filter removal, installation, and orientation.

Ensure Dichroic Coating is toward the lamp, with the thickest part of the wedge toward the mounting surface of the optical housing.

Instruction Manual
Style 3
Taxiway Centerline Light L-852A-C
Inset Runway Guard Light L-852G
Inset Stopbar Light L-852S

Figure 2 Wedge Filter Bracket Assembly

Refer to Figure 2 for wedge-filter bracket assembly details. Assemble the inner cover onto the light housing. The screw hole patterns in the inner cover and light housing are offset to insure proper alignment. Torque the mounting screws to 30 in-lbs. Perform a pressure test per paragraph 10.10. Clean the mounting flange area of the support ring. Place the Optical Assembly into the support ring. Install new stainless steel, split-ring lock washers. Apply Loctite 242 (P/N 10048-30), per manufacturer's instructions, to both mounting bolts and immediately torque them to 225 -0+10 in-lbs.

10.10 Pressure Test

A light fixture should be subjected to a 20-psi air pressure test to verify that it is waterproof whenever it has been opened or components have been replaced. A tire valve style pressure fitting is located on the bottom of the inner cover. Pressurize the fixture to 20-psi then place it in a tub of water or use a soap solution to locate escaping air bubbles. Carefully inspect the areas around the lens, inner cover seal, and feed-thru adapter for leaks. Relieve the internal air pressure before installing the fixture or attempting to repair a leak.

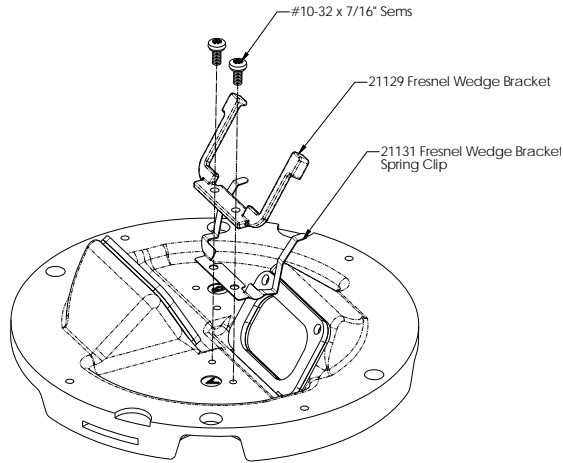

WARNING

WARNING:

Do not exceed 20 psi when pressure testing the fixture. Serious injury and/or permanent damage to the fixture may result if a higher air pressure is used. Once the pressure test is complete be sure to relieve the air pressure.

Instruction Manual
Style 3
Taxiway Centerline Light L-852A-C
Inset Runway Guard Light L-852G
Inset Stopbar Light L-852S

10.11 Cleanliness and Workmanship

Service life depends upon the entire assembly being waterproof. All surfaces must be clean, dry and free of all foreign matter if the light fixture is to operate for extended periods without requiring maintenance.

10.12 Maintenance Program

In order to insure maximum light fixture life, the installed units should be subject to a maintenance program in accordance with the following:

- 10.12.1 Regular cleaning is necessary in order to insure that inset lighting fixtures operate at maximum efficiency. The lens and channel in front of the lens should be cleaned periodically with a soft cloth and solvent. The weather and the location of the fixtures will dictate the regularity and type of cleaning.
- 10.12.2 Snowplow operators should exercise extra care not to strike the light fixtures with snowplow blades. After snowplow removal operations, inspect all light fixtures to locate and replace if necessary, any damaged Light Assemblies. Passes over the light rows should be made with a power broom only if practical. Whenever snowplows must traverse in-pavement light fixtures, they should be traveling at less than 5 mph or have the blades lifted clear of the fixtures. Recommended snow removal techniques are described in AC 150/5200-23.
- 10.12.3 The light is designed to exclude both ground and surface water from entering. If the lights are not properly maintained (i.e., bolts tightened and seals in good condition) water may enter the fixture. To prevent this from occurring, it is recommended that each fixture be inspected for the presence of water at least once a month. More frequent inspection is desirable during and following rainy seasons
- 10.12.4 Optical Assembly and support ring hold-down bolts should be checked for proper torque (225 +5, -0 in-lbs.) at least once every three months or whenever a fixture is serviced regardless of the season. Light fixtures in and around high speed exit areas are especially prone to vibration damage if the mounting bolts are not properly torqued. It is recommended that Loctite 242 be used on mounting bolts to prevent loosening due to vibration. The mounting surface of the light base must be clean and free of foreign matter when checking mounting bolts.
- 10.12.5 If any fixture contains water, the water should be removed and the entire fixture cleaned and dried. Perform a pressure test per paragraph 10.10 to locate the source of the leak. Replace the bottom cover gasket, or optical housing o-ring, See Sections 10.3, 10.4 and 10.5.

Instruction Manual
Style 3
Taxiway Centerline Light L-852A-C
Inset Runway Guard Light L-852G
Inset Stopbar Light L-852S

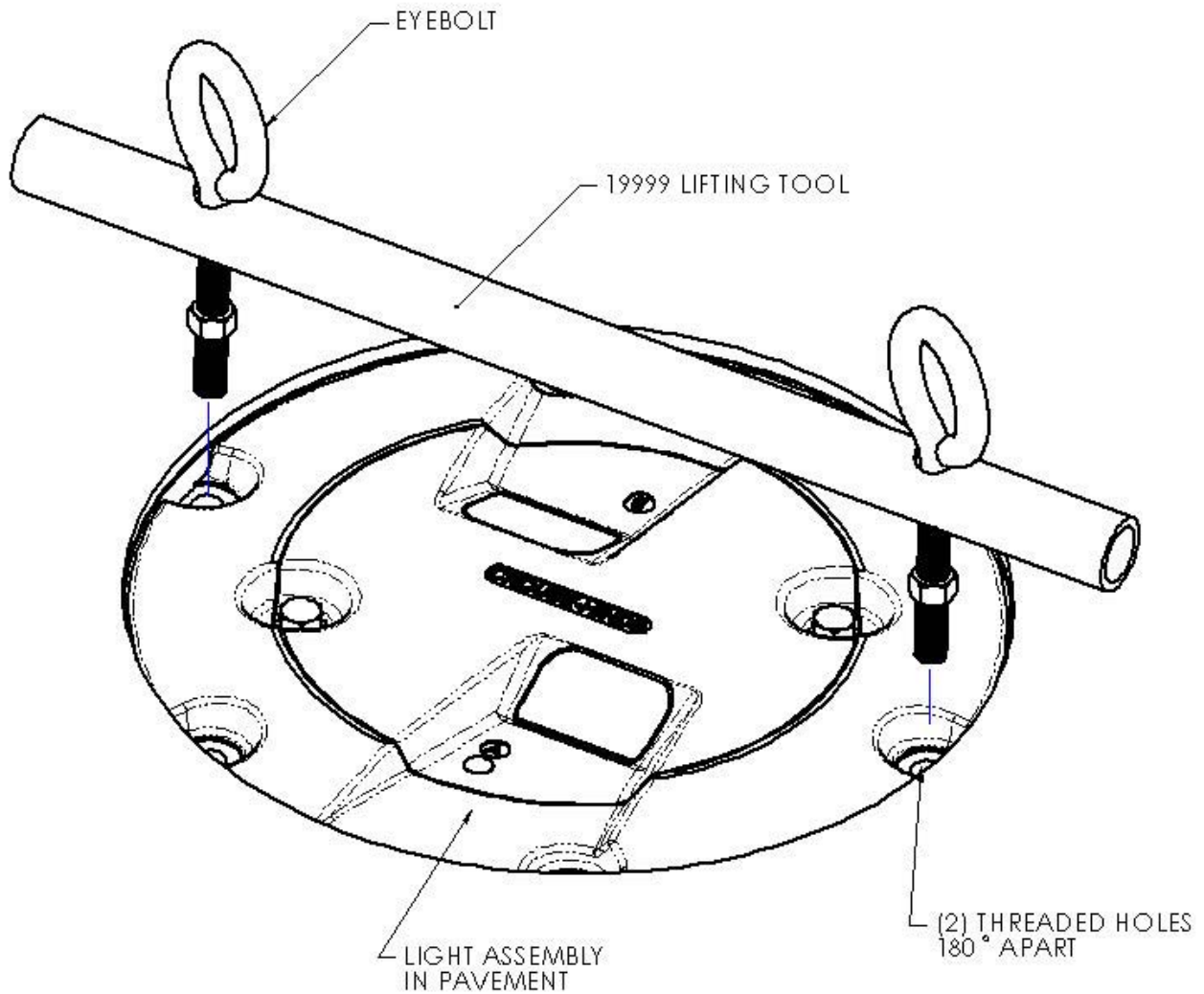

**Figure 3 19999 Installation (Lifting) tool
TCL fixture shown**

Instruction Manual
Style 3
Taxiway Centerline Light L-852A-C
Inset Runway Guard Light L-852G
Inset Stopbar Light L-852S

11 PARTS LIST

ITEM	PART NUMBER	852A3 QTY	852B3 QTY	852C3 QTY	852G3 QTY	852S3 QTY	DESCRIPTION
1	21100 *	2	2	2	1 OR 2	1 OR 2	BRACKET, LENS RETAINING, 18-8 STN STL.
2	21101 *	2	2	2	1 OR 2	1 OR 2	GASKET, LENS RETAINING
3	21102-C *	2	2	2	A/R	A/R	LENS, CLEAR BI-DIR, QTY = 2 UNI-DIR, QTY = 1
4	21103 *	2	2	2	A/R	A/R	BOOT, LENS BI-DIR, QTY = 2 UNI-DIR, QTY = 1
5	21105-1	0	0	0	A/R	A/R	OPTICAL HOUSING, MACHINED, UNIDIRECTIONAL
6	21105-2	1	1	1	A/R	A/R	OPTICAL HOUSING, MACHINED, BIDIRECTIONAL
7	10C10-037D40	2	2	2	2	2	BOLT, 3/8-16 X 1.5 LG., 18-8 STN STL.
8	21112	1	1	1	1	1	SUPPORT RING, MACHINED/PLATED, DUCTILE IRON
9	21461	2	2	0	1	1	LAMP BRACKET ASSEMBLY, 304 STN STL.
10	21127	1 OR 2	1 OR 2	1 OR 2	0	0	LAMP/REFLECTOR ASSEMBLY, 32 W, 6.6A.
11	21128	0	0	0	1	1	LAMP/REFLECTOR ASSEMBLY, 105 W, 6.6 A.
12	21118-1	0	0	0	A/R	A/R	BOTTOM COVER, MACHINED, 1 THREADED LEAD HOLE
13	21118-2	1	1	1	A/R	A/R	BOTTOM COVER, MACHINED, 2 THREADED LEAD HOLE.S
14	21120	2	2	2	1 OR 2	1 OR 2	ADAPTER, THREADED, FEED-THRU
15	21121	A/R	A/R	A/R	0	0	FEED-THRU ASSEMBLY, P2 VERSION, QTY = 1
16	21122	A/R	A/R	A/R	1	1	FEED-THRU ASSEMBLY, P1 VERSION, QTY = 1
17	21145	1	1	1	0	0	BAFFLE P2 VERSION ONLY
18	10000-471	1	1	1	1	1	SCREW, SEMS, PAN HD TYPE 1A CROSS, GREEN, #10-32 X 3/8 LG, 18-8 STN STL.
19	10000-468 *	4	4	4	2 OR 4	2 OR 4	SCREW, SEMS, PAN HD TYPE 1A CROSS/DRI-LOC, #10-32 X 1/2 LG, 18-8 STN STL.
20	10000-469	A/R	A/R	A/R	5	5	SCREW, SEMS, PAN HD P1-1 COLOR VERSION QTY =5, TYPE 1A CROSS/DRI-LOC, P1-2 COLOR VERSION QTY= 10 #8-32 X 3/8 LG, 18-8 STN STL.
21	10000-470	4	4	4	4	4	SCREW, FLAT HD/DRI-LOC, #10-32 X 7/16 LG, 18-8 STN STL.
22	10038-43	2	2	2	2	2	DOWEL PIN, 3/8 X 3/4 LG,
23	21129	1 OR 2	1 OR 2	1 OR 2	1	1	WEDGE FILTER COLOR/COLOR FIXTURE QTY = 2 BRACKET COLOR BLANK FIXTURE QTY = 1
24	21131	1 OR 2	1 OR 2	1 OR 2	1	1	WEDGE BRACKET COLOR/COLOR FIXTURE QTY = 2 SPRING CLIP COLOR BLANK FIXTURE QTY = 1
25	21132	2 OR 4	2 OR 4	2 OR 4	2	2	FRESNEL WEDGE COLOR/COLOR FIXTURE QTY = 2 GASKET COLOR BLANK FIXTURE QTY = 1
26	21438-Y	A/R	0	A/R	0	0	FILTER ASSEMBY W/BAFFLE, L-852A, YELLOW
27	21438-G	A/R	0	A/R	0	0	FILTER ASSEMBY W/BAFFLE, L-852A, GREEN
28	21436-Y	0	A/R	0	0	0	FILTER ASSEMBY W/BAFFLE, L-852B, YELLOW
29	21436-G	0	A/R	0	0	0	FILTER ASSEMBY W/BAFFLE, L-852B, GREEN
30	21130-TR	0	0	0	0	1	FRESNLE, WEDGE, TRAFFIC SIGNAL RED
31	21130-TY	0	0	0	1	0	FRESNEL, WEDGE, TRAFFIC SIGNAL RED
32	10037-795	1	1	1	1	1	FITTING, PRESSURE TEST, 1/8 NPT
33	11A12-037D	2	2	2	2	2	WASHER, LOCK, 3/8, 18-8 STN STEEL
34	10048-25*	A/R	A/R	A/R	A/R	A/R	SILICONE GREASE
35	10048-106	A/R	A/R	A/R	A/R	A/R	PIPE SEALANT PASTE
36	10035-61	2	2	2	1	1	O-RING, FEED-THRU ADAPTER
37	21124	1	1	1	1	1	GASKET, BOTTOM COVER (SEE SECTION 10.3)
38	21109	A/R	A/R	A/R	A/R	A/R	FEED-THRU PLUG, ALUMINUM
39	21143	A/R	A/R	A/R	A/R	A/R	BLANK COLOR LENS RETAINING GASKET
40	10048-30	A/R	A/R	A/R	A/R	A/R	MEDIUM STRENGTH THREADLOCKER, LOCTITE 242
41	10035-62	1	1	1	1	1	O-RING, 3/32, (SEE SECTION 10.3)
42	21180	A/R	A/R	A/R	A/R	A/R	EXTERNAL SUPPORT RING GASKET (OPTIONAL)
43	21435	0	0	2	0	0	LAMP BRACKET ASSEMBLY, L-852C
44	21483-Y	0	0	A/R	0	0	FILTER ASSEMBLY W/BAFFLE, L-852C, YELLOW
45	21483-G	0	0	A/R	0	0	FILTER ASSEMBLY W/BAFFLE, L-852C, GREEN
46	21226	2	0	0	0	0	LAMP BRACKET ASSEMBLY, L-852A

Instruction Manual
Style 3
Taxiway Centerline Light L-852A-C
Inset Runway Guard Light L-852G
Inset Stopbar Light L-852S

* - THESE PARTS ARE INCLUDED IN A P/N 21126-C LENS REPLACEMENT KIT, EACH KIT CONTAINS PARTS TO REPLACE ONE LENS

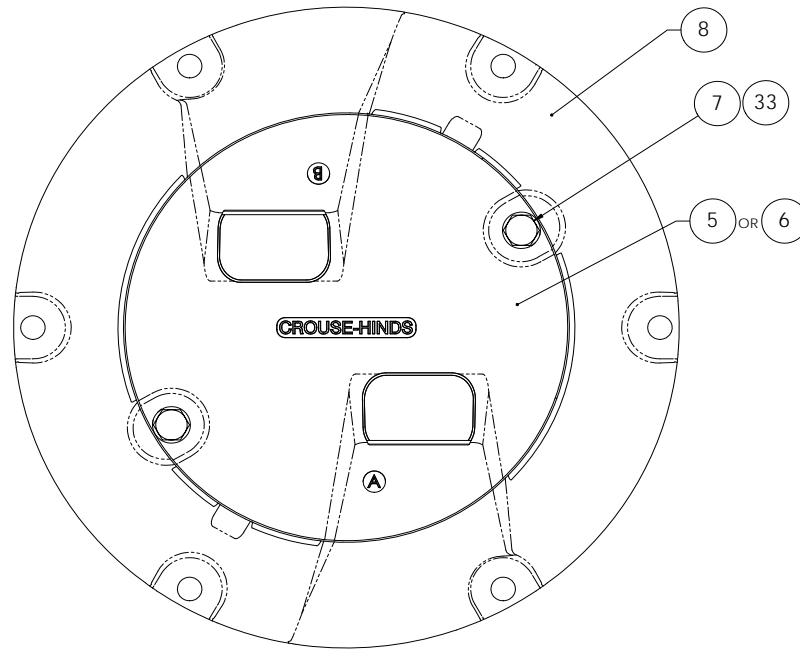

Figure 4 Top View of Fixture

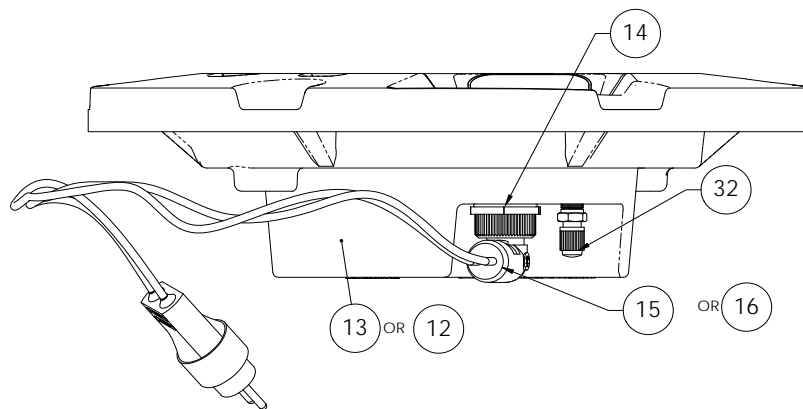

Figure 5 Side View of Fixture

Instruction Manual
Style 3
Taxiway Centerline Light L-852A-C
Inset Runway Guard Light L-852G
Inset Stopbar Light L-852S

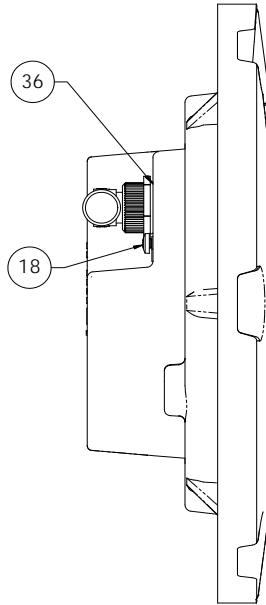

Figure 6 Feed-thru adapter detail

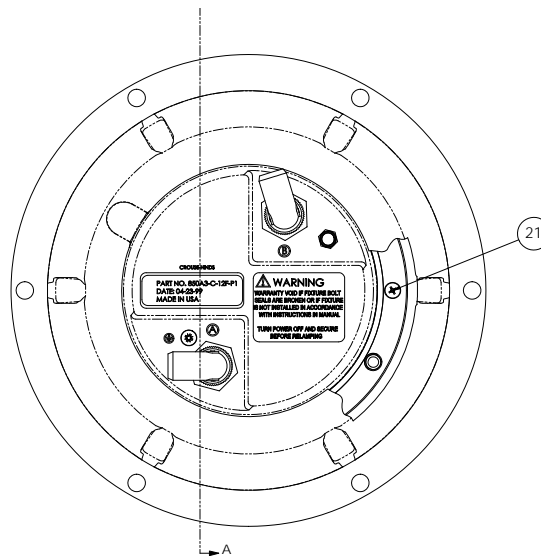

Figure 7 Bottom View of Fixture

Instruction Manual
Style 3
Taxiway Centerline Light L-852A-C
Inset Runway Guard Light L-852G
Inset Stopbar Light L-852S

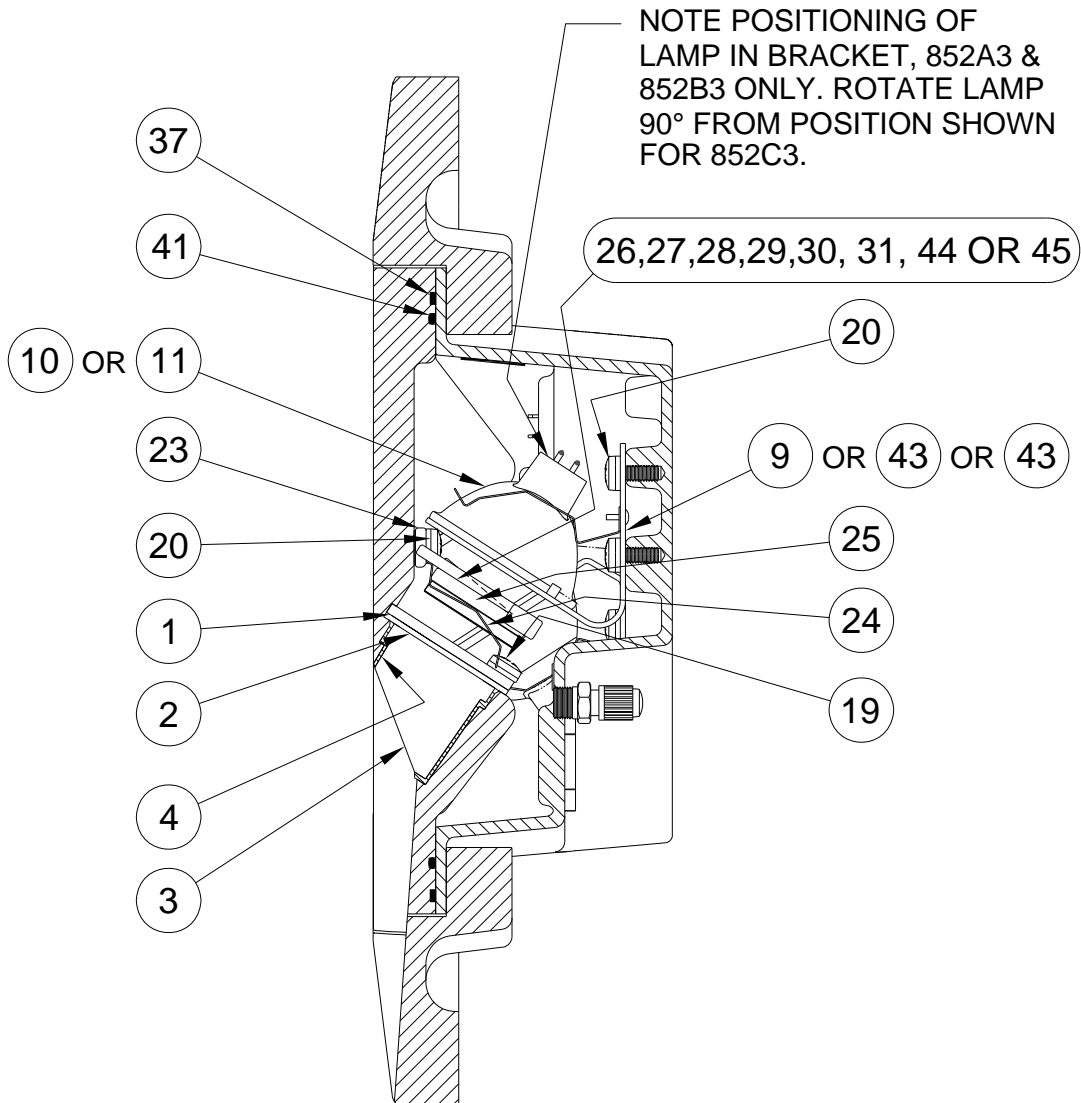

Figure 8 Cut Away View of Fixture

Instruction Manual
Style 3
Taxiway Centerline Light L-852A-C
Inset Runway Guard Light L-852G
Inset Stopbar Light L-852S

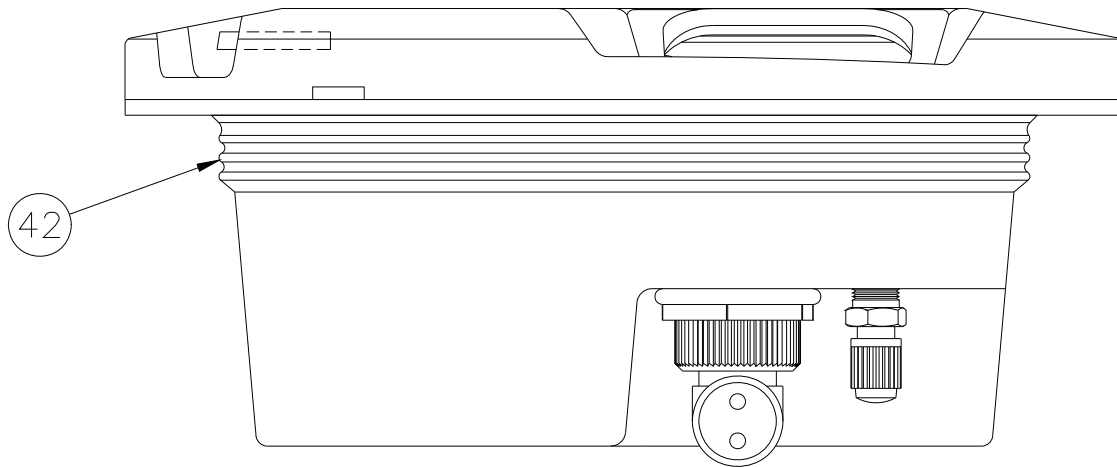

Figure 9 Side View of Fixture with Optional External Support Ring Gasket